

KICKASS

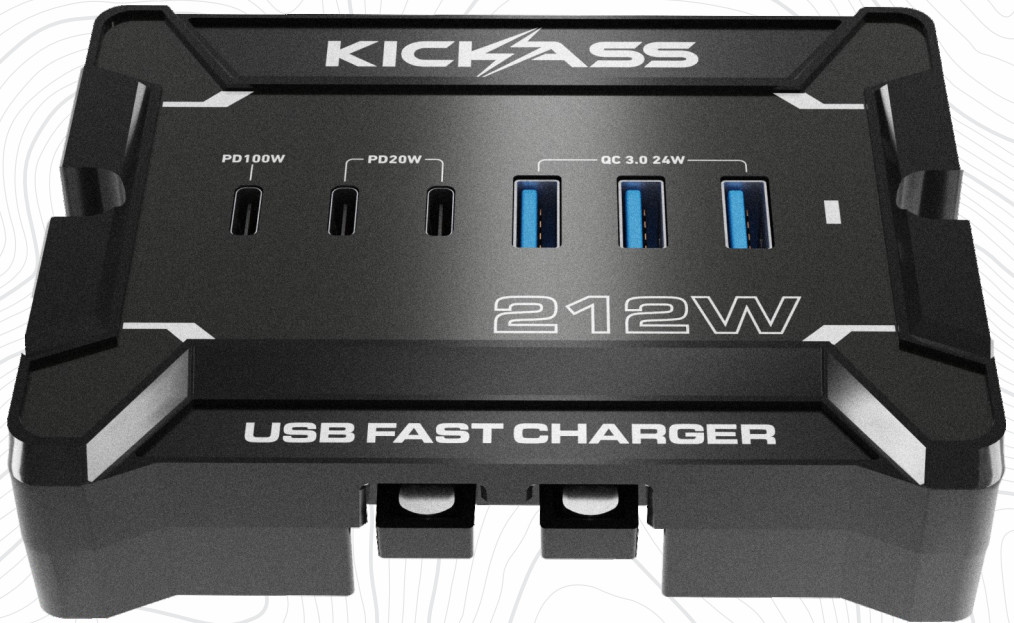

**12V ANDERSON TO USB
FAST CHARGER - 212W**

OWNER'S MANUAL

KAFC12V212W

VER 1.2

TABLE OF CONTENTS

INTRODUCTION -----	1
PRODUCT SPECIFICATIONS -----	1
WARNING -----	2
PRODUCT OVERVIEW -----	2
OPERATION -----	3
WARRANTY & SUPPORT INFORMATION -----	5

INTRODUCTION

The KickAss 12V Anderson to USB Fast Charger is the ultimate power solution for off-grid explorers. Delivering an impressive 212W of total power, it can rapidly charge laptops, drones, camera gear, camping essentials like lights and power packs, as well as portable gaming consoles — all from your dual battery setup. Designed with a built-in Anderson plug for seamless plug-and-play compatibility with Anderson-compatible systems, this charger supports fast, simultaneous charging of up to six devices. Whether you're on a rugged 4WD adventure or camping in your caravan, this compact, high-powered charger is a must-have for any off-grid enthusiast looking to stay connected and powered up. (Powered by a 12-volt Anderson cable — not included).

To ensure safe and effective use, please read this manual carefully before operating. It contains important safety precautions, technical specifications and operation instructions. Please follow the usage guidelines and observe all warnings to avoid personal injury or product damage.

PRODUCT SPECIFICATIONS

INPUT VOLTAGE	12V DC
TOTAL OUTPUT POWER	212W Max
USB-C PD	1 x 100W
USB-C PD	2 x 20W
USB-A QC3.0	3 x 24W
MAXIMUM INPUT POWER	280W
STANDBY POWER	0.26W
WORKING TEMPERATURE RANGE	-10°C to 50°C

WARNING

To ensure your safety and extend the life of your Fast Charger, please note the following:

- This product is not a toy, and should not be used by children. Misuse can cause damage or injury.
- For 12VDC power supply only. Do not exceed 16V or higher voltage.
- Always ensure the input polarity (Anderson connector) is correct. Reversing the connection can cause permanent damage to your equipment. Standard wiring: Red wire = positive (+), Black wire = negative (-).
- Do not use in wet, high-heat, or flammable environments.
- Do not attempt to disassemble, modify, or repair the charger. Doing so will void the warranty and could lead to electrical shock, fire, or injury. Contact customer support for any service needs.

PRODUCT OVERVIEW



1. 100W USB-C PD Port
2. 20W USB-C PD Port
3. 24W USB-A QC 3.0 Port

4. Mounting Points
5. Built-in Anderson Plug
6. LED Indicator

OPERATION

Connect the Charger to the Power Source:

- Using an Anderson connector cable (this product features a built-in Anderson input port), insert one end into the Anderson connector on the side of your KickAss Fast Charger.
- Insert the other end of the cable into the corresponding Anderson output port on your 12V power source.
- Ensure the connection is firm and correct. Standard wiring: Red wire = Positive (+), Black wire = Negative (-).

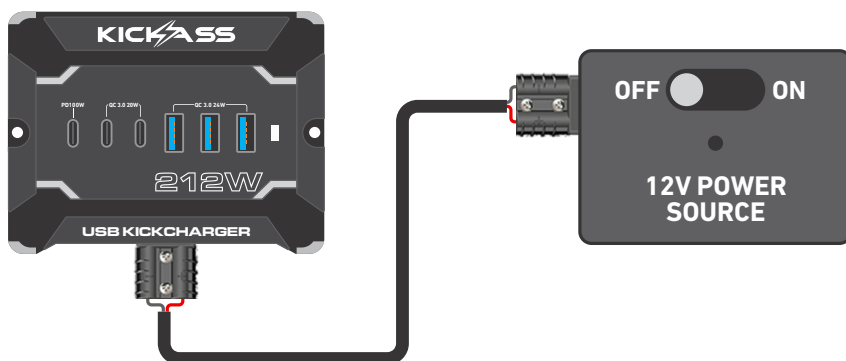

Activate the Power Source:

- Turn on the power output function of your 12 V power source.
- At this point, the indicator light on the KickAss Fast Charger should light up, indicating that the device is powered on and ready.

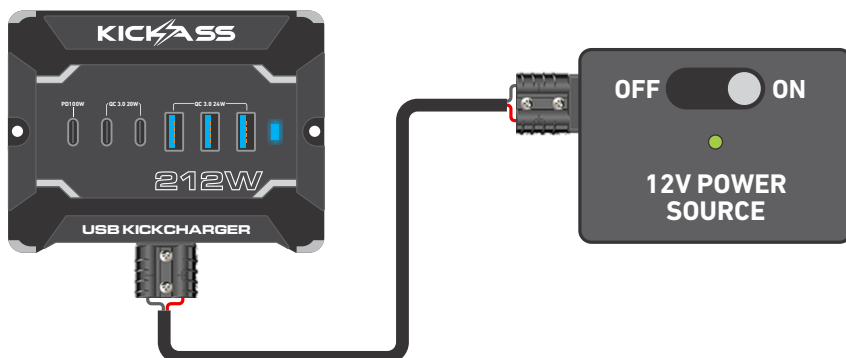

Connect and Charge Devices:

- Based on your device type and charging requirements, select the appropriate charging port on top of the charger.
- For power hungry devices such as laptops, use the PD 100W USB-C port.
- Connect your device to the selected port, and it should begin charging.

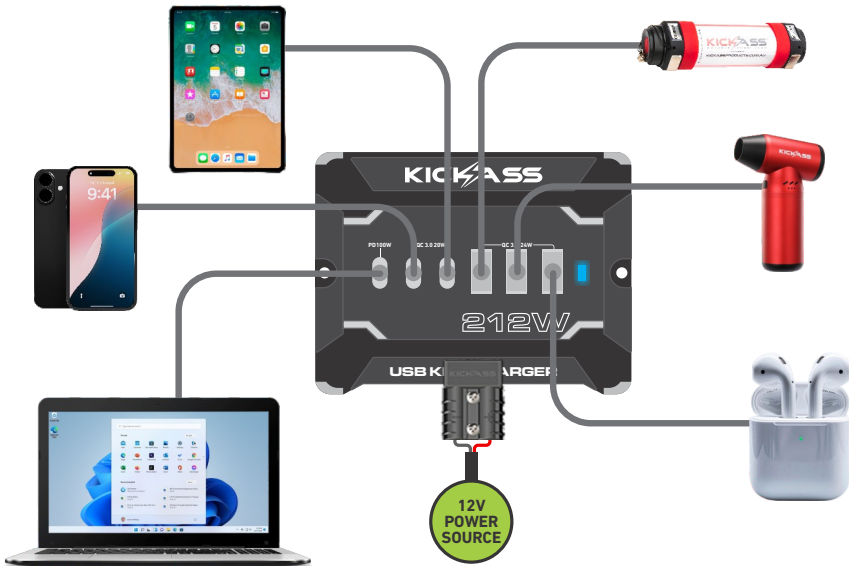

Disconnect Your Devices:

- When your device is fully charged or you no longer need to continue charging, disconnect your device from the charger.

WARRANTY & SUPPORT INFORMATION

Need help?

For product support or to make a warranty claim, reach out to the KickAss Customer Service team on: warranty@kickassproducts.com.au

Alternatively, visit our Customer Support Portal at:

<https://supportportal.kickassproducts.com.au/>

KICKASS

**KickAss is a registered trademark of
KickAss Products Pty Ltd**

**Designed & imported by
KickAss Products Pty Ltd
39 Iris Place, Acacia Ridge, QLD 4110
Australia**

Made in China

