

**THETFORD**



# USER MANUAL

# Refrigerator

**N4000 series**

**For the Australian market**

# EN

## Original User Manual

## Contents

1	Introduction.....	2
2	Safety.....	3
3	Overview.....	8
4	Before use.....	10
5	Use.....	11
6	Maintenance and cleaning.....	16
7	Disposal.....	21
8	Technical specifications.....	22
9	Service & questions.....	22

## 1. Introduction

### General

This is the user manual for your Thetford refrigerator.

Read the safety instructions and information on use and maintenance of the refrigerator carefully before continuing. This will enable you to use the refrigerator safely and efficiently. Retain this manual for future reference.

This document is version 692276/0424-V04 of the user manual. Please visit [www.thetford.com](http://www.thetford.com) for the most recent version.

### Symbols

The following symbols may be used in this manual:



**Warning.** Risk of serious injury and/or damage.



**Caution** Risk of moderate injury and/or damage.



**Attention.** Important information.



**Note.** Additional information.



**Video.** Additional instruction video available.

## 2. Safety

The Thetford N4000 series is a range of absorption refrigerator suitable of running on running on three different power sources; ULPG, 12V DC and 240V AC. The refrigerator automatically selects the best power source.

Please read the safety instructions carefully before using the appliance.

### General



DO NOT SPRAY AEROSOLS IN THE VICINITY OF THIS APPLIANCE WHILE IT IS IN OPERATION.



DO NOT USE OR STORE FLAMMABLE MATERIALS IN OR NEAR THIS APPLIANCE.



DO NOT PLACE ARTICLES ON OR AGAINST THIS APPLIANCE.



DO NOT MODIFY THIS APPLIANCE.

### Children and vulnerable people



Risk of serious injury through burns, explosion, suffocation, electrocution, fire and poisoning or damage to the appliance.

- This appliance may be used by children aged 8 years or older and persons with reduced physical, sensory or mental capabilities and/or lack of experience and knowledge only if they are supervised or have been given instructions on the safe use of this appliance and understand the potential hazards.
- Keep children younger than 8 years away from the appliance, except under constant supervision.
- Do not allow children to play with the appliance. Children can become trapped and possibly suffocate.
- A number of shelves and drawer dividers are secured to prevent inadvertent entrapment and possible suffocation of children. Do not remove or reposition them.
- Do not allow children to clean or maintain this equipment unattended.

## Use of the appliance



Risk of health issues or damage to the appliance.

- Use the appliance for cooling and keeping frozen food frozen only and not for anything else. Follow the instructions in this manual. The manufacturer cannot be held liable for damage resulting from improper use or incorrect setting of the controls. If the instructions have not been followed, warranty claims will not be accepted.
- Do not use electrical devices in the appliance.
- Do not place articles on or against this appliance or use the area behind the refrigerator to store anything. This may block the air flow or create a fire hazard.
- Do not spray liquids near electrical outlets, connections or the refrigerator components. Many liquids are electrically conductive and can cause a shock hazard, electrical shorts and in some cases fire.
- Keep ventilation openings, in the appliance enclosure or in the built-in structure, clear of obstruction.
- Never expose the appliance to moisture and/or rain.
- Never keep carbonated liquids in the frozen food compartment.
- Never eat ice-cubes or popsicles directly out of the frozen food compartment. This can cause burns.
- Do not use the drawer as a step or ladder.



### General use

- This appliance is connected to more than one source of energy.
- This appliance is intended for use in mobile leisure vehicles.
- Actual energy consumption of the refrigerator depends on the cooling setting, ambient temperature, and the content of the refrigerator.
- When the vehicle is exposed to full sun light, it is strongly recommended to apply proper ventilation in the vehicle.



### Use of food

- To prevent ice build-up in your refrigerator, always cover liquid products, let warm products cool down before placing them inside the refrigerator. Do not open the door any longer than necessary.
- Only store food items in the refrigerator which are wrapped or packed to avoid direct contact with interior.
- Opening the door for long periods can cause a significant increase of the temperature in the compartments of the appliance.
- Two-star frozen-food compartments are suitable for storing pre-frozen food, storing or making ice-cream and making ice cubes.
- One-, two- and three-star compartments are not suitable for the freezing of fresh food.

- Respect the expiry date printed on the packaging of food.
- Defrosting, cleaning or maintenance of the refrigerator can shorten the preservability of food.
- As the constant regulation of temperature can not be guaranteed, the refrigerator might not be suitable for proper storage of medications. Refer to the instructions included with the medications.

## Maintenance and cleaning



Risk of serious injury through and electrocution or damage to the appliance.

- Before carrying out any kind of maintenance or cleaning on the refrigerator, switch it off, disconnect the AC and DC power sources, and close the regulator on the gas bottle.
- Do not use mechanical devices or other means to accelerate the defrosting process, other than those recommended by the manufacturer.
- Do not speed up the defrosting process by removing the ice layer with force or sharp objects or by using a hair-dryer or any other electrical device.
- At regular intervals, make sure that the refrigerator flue, the burner, the vent areas and the ventilation air pathway between the vents are completely free from any flammable material or blockage. After a period of storage, it is especially important to check these areas for any flammable material or blockage caused by animals.
- Only for maintenance purposes it is allowed to remove a secured storage shelf or secured drawer divider. Always replace and secure the storage shelf or drawer divider to the exact same installation position after maintenance.
- Do not use abrasive cleaners, metal scouring pads or hard brushes. They could damage the refrigerator.
- Never clean the refrigerator with soap or aggressive, caustic or soda-based cleaning agents.
- Do not expose the refrigerator to water. Water through the vents may damage your refrigerator.
- The loose parts of the refrigerator are not suitable for the dishwasher.

## Servicing and troubleshooting



Risk of serious injury through burns, explosion, suffocation, electrocution, fire and poisoning or damage to the appliance.

- All servicing must be carried out by an approved competent person, according local regulations.
- Make sure that installation, electrical connection, maintenance and periodical inspection of the ULPG system are completed by a qualified technical person, according to Thetford's instructions ([www.thetford.com.au](http://www.thetford.com.au)) and local safety rules.

- Let a qualified person perform a yearly inspection of the gas system, the burner area and the combustion seal to repair any damages or malfunctions.
- If you smell a pungent odour from the cooling system: Switch off the refrigerator, extinguish any naked flames, provide sufficient ventilation through vents, windows and doors. Then contact the Customer Service Department in your country or holiday location.
- Never attempt to repair parts of the ULPG system, the ULPG flue or electrical components by yourself. The repairs may only be done by a qualified technician. Please contact the Customer Service Department for further support and addresses.
- Never open or damage the refrigerant circuit of the cooling system at the back or on the inside of the appliance. The cooling system is pressurised and contains substances that can be harmful to your health.
- Do not modify the appliance and its components, unless the modification is authorised by the manufacturer.
- Use only parts supplied by the manufacturer.
- Do not change or adjust anything on the appliance, unless the change is authorised by the manufacturer or its representative.

## Electricity



Risk of serious injury through electrocution, burns and fire or damage to the appliance and the surrounding.

- When positioning the appliance, ensure the supply cord is not trapped or damaged.
- If a supply cord is damaged, have it be replaced by the manufacturer, its service agent or similarly qualified person in order to avoid a hazard.
- Do not locate multiple portable socket-outlets or portable power supplies at the rear of the appliance.

## Gas



Risk of serious injury through burns, explosion, suffocation and poisoning or damage to the appliance and the surrounding.

- The refrigerator only runs on ULPG (propane, butane or a mixture of these both). It does not run on natural gas or coal gas.
- Only use gas which is mentioned on the serial label inside the refrigerator.
- If you smell ULPG (gas): Directly close the valve of the ULPG bottle, extinguish any naked flames, do not switch on any electrical devices or lighting, open the windows and leave the room. Then contact the Customer Service Department in your country or holiday location.
- While driving, it is only allowed to run the refrigerator on gas if the vehicle is equipped with a safety closing device according to the local regulations in force.
- Do not use ULPG to power the refrigerator in the vicinity of petrol stations.
- Do not use the refrigerator on gas when vehicle is located indoors.

- A filter must be used when operating on Liquefied Petroleum Gas (LPG). The filter must be prescribed by a qualified technical person.
- Make sure the type and position of the ULPG bottle meets the latest technical regulations.
- Change the ULPG bottle in open air and out of reach of any possible source of ignition.
- Never obstruct the ventilation openings in the ULPG bottle storage location.

## Storage



Risk of damage to the appliance due to flooding and moisture.

- Make sure the gas taps of the gas bottle are closed during storage.
- Water flowing through the outside vents can damage the refrigerator. Make sure the vent openings are covered before washing the vehicle before storage.
- To prevent mould from forming in the appliance take care before storage; switch off the appliance, defrost it, clean it, dry it and leave the door open.

## Environmental



The refrigerant is ammonia and insulation blowing gases is cyclopentane (C5H10), servicing and disposal of appliance should be done by qualified person.



When the vehicle is exposed to full sun light, it is strongly recommended to apply proper ventilation in the vehicle to reduce energy consumption.

### 3. Overview

#### Model N4141

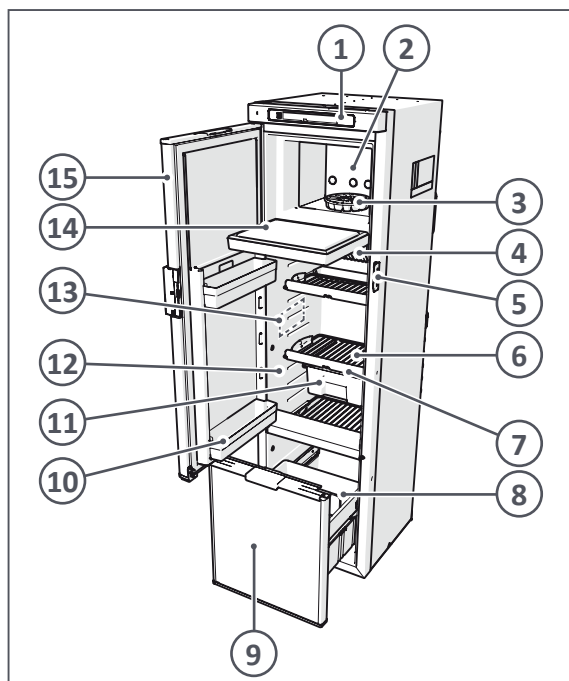

1. Control panel
2. Frozen food compartment
3. Ice cube tray
4. Door lock
5. Storage shelves
6. Shelf food retainer (optional)
7. Drawer divider
8. Drawer for bottles and vegetables
9. Door bins
10. Slide-out box
11. Fresh food compartment
12. Serial ID label
13. Frozen food compartment door
14. Refrigerator door



## Model N4175 and N4208

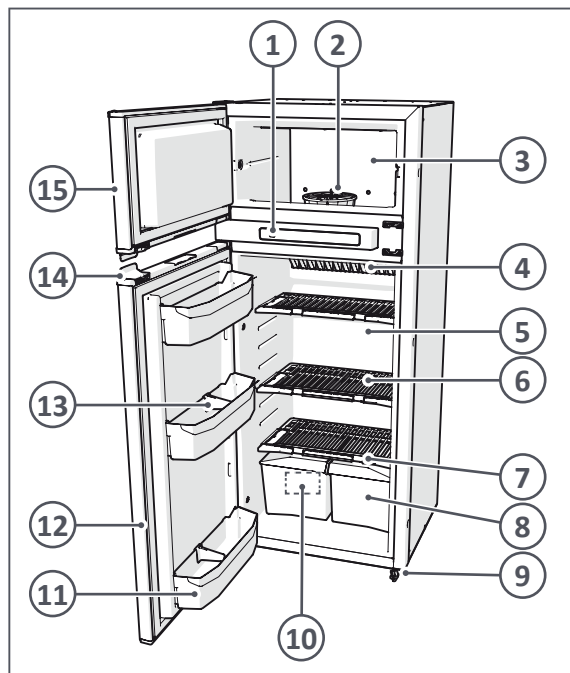

1. Control panel
2. Ice cube tray
3. Frozen food compartment
4. Cooling fins
5. Fresh food compartment
6. Storage shelves
7. Shelf food retainer
8. Vegetable bins
9. Security lock (not present on all refrigerators)
10. Serial ID label
11. Door bins
12. Fresh food compartment door
13. Bottle retainer
14. Door lock
15. Frozen food compartment door

## LCD touchscreen

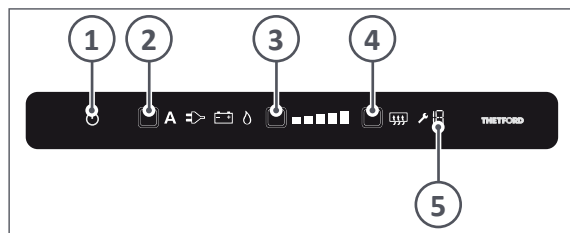

1. On/off button
2. Energy source button
3. Cooling level button
4. Anti-condensation button (except N4141)
5. Error code

## 4. Before use



Read the applicable instructions in chapter Safety first.

Before using the appliance:

- Ensure that all packaging materials have been removed.
- Clean the inside of the appliance with warm water and household detergent and dry carefully with a soft cloth.
- Ensure that the DC/AC electricity supplies are connected and turned on.
- Ensure that the gas supply is connected and turned on.

### Energy sources

There are four available functions:



**AUTO:** Automatically selects the desired source (in order: mains, battery, ULPG)

- The control panel shows the A and the best source available.



**240V AC – Mains**

- This refrigerator is equipped with electronics to ensure optimal cooling performances at all input voltages between 210V and 250V.



**12V DC – Battery of the vehicle**

- Operating on 12V is only effective while the engine of the vehicle is running.
- The performance of the refrigerator when operating on 12V is dependent on the thickness and length of the wiring and the overall installation of the (towing) vehicle.
- In case the refrigerator is installed in a caravan, the refrigerator needs a D + signal (engine running) from the towing vehicle to operate in DC mode while travelling.
- The Recreational Vehicle manufacturer can choose to shut off the 12V option as an energy source.



### ULPG – Gas connection of a ULPG bottle

- When using ULPG, make sure the ULPG bottle valve is opened.
- Make sure the control panel is powered from the battery or AA batteries (in the case of a stand-alone model).
- When selecting gas, the flame should be ignited within 30 seconds. If the system fails, restart the refrigerator and select the gas source again. For safety reasons, you cannot run the refrigerator on gas within 15 minutes of parking the vehicle, after switching off the engine.
- From about 1000m above sea level, problems of a physical nature can occur when lighting the ULPG. This does not mean that the refrigerator is not working properly.

## 5. Use



Read the applicable instructions in chapter Safety first.

### Switch on

To switch on the refrigerator:

- Push the on/off button. The light in the on/off switch turns on and the selected settings are shown on the display.



After 10 seconds, the settings indication will dim. The light indicates the refrigerator is still in function.



For optimal performance, level your vehicle and switch on the refrigerator 8 hours before placing food.

### Selecting source

To select the source:

- Push the source button several times until the desired source is selected.



Always use the gas connection or mains voltage to start up and cool.



This appliance needs 12V for controls independent on the energy source selected.



If the refrigerator is powered by a gas connection, make sure the control panel is powered from the battery.

## Select cooling level

To select the cooling level:

- Push the cooling level button several times until the desired cooling level is selected.



Thetford advises to set the refrigerator on cooling level 3, with an ambient temperature between 15°C and 25°C. A higher temperature needs a higher cooling level, a lower temperature a lower level.



The refrigerator will stop cooling during power shortage. Once the power is restored the controls will restart the refrigerator



In case of a power shortage keep the doors of the refrigerator closed to maintain the cool temperature inside.

## Operating options

### Anti-condensation

To prevent the control panel from condensation, the anti-condensation function is automatically switched on. Only switch off this function when there is little energy. To switch off the function:

- Push the anti-condensation button. The symbol on the control panel will light up.
- Push the button again to switch on the anti-condensation function again.

### Cooling fans

The refrigerator is fitted with internal- and external fans to ensure proper cooling. These fans are designed to turn on automatically when ambient temperatures rise above certain levels.

## Switch off

To switch off the refrigerator before defrosting or storing your vehicle:

- Push the on/off button. All lights will dim.

## Use of the fresh food compartment

To best fill the refrigerator, keep the following in mind:

- Place food after a minimum of 8 hours of cooling the refrigerator.
- Store only pre-cooled food, to reduce the cooling time.
- Store food separately in closed boxes, to prevent for odours and food from drying out.
- Make sure air can still circulate around the fins. Do not completely cover the cooling fins with food, to preserve an optimal performance.



The maximum load of the large shelf is 12 kg and the maximum load of the small shelf is 6 kg.



The maximum storage capacity of the drawer is 15kg.

To organise your refrigerator as desired, the unsecured storage shelves, drawer dividers and door bins can be moved.



Do not remove or reposition the secured shelves or secured drawer dividers, so children have no space to be entrapped in the refrigerator.



Ensure that the door can still be closed after reorganizing shelves and bins.

### Moving the door bins

- Push the door bin out of the lock with both hands.
- Place the door bin back in the desired position.

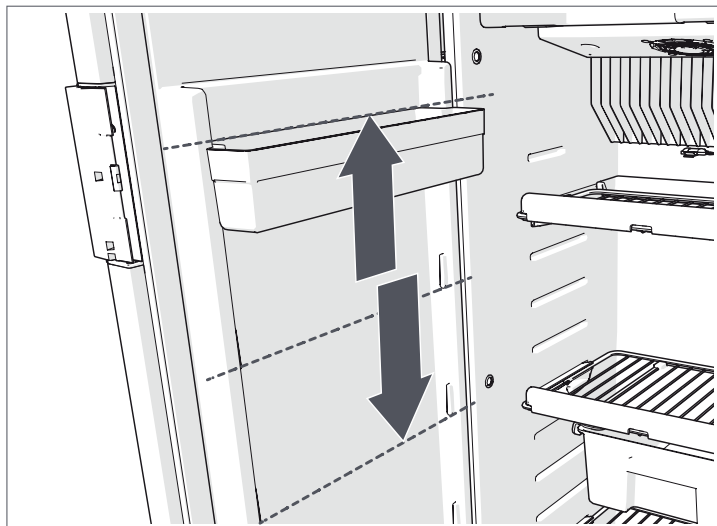

- Push the door bin back on the lock.

### Moving drawer divider (model N4141)

The drawer is specially designed for bottles, cans and vegetables. To divide the drawer into two compartments:

- Take the bottle retainer from the back and place it back in a desired groove.

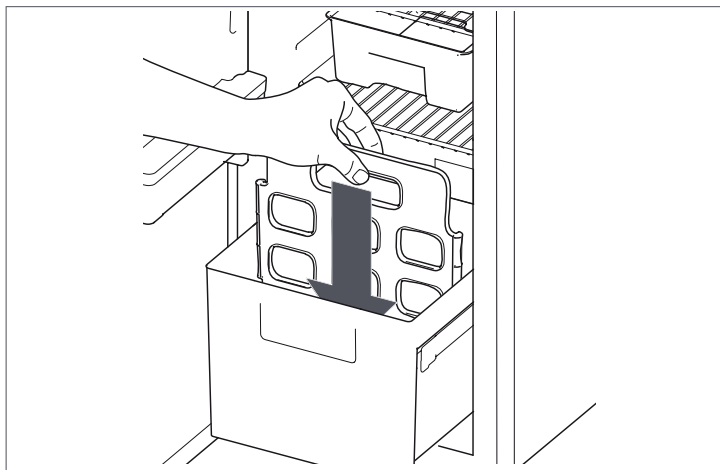

### To reposition an unsecured storage shelf (model N4141)

- Turn the plastic clamp of the storage shelf upwards
- Lift the left side a bit.

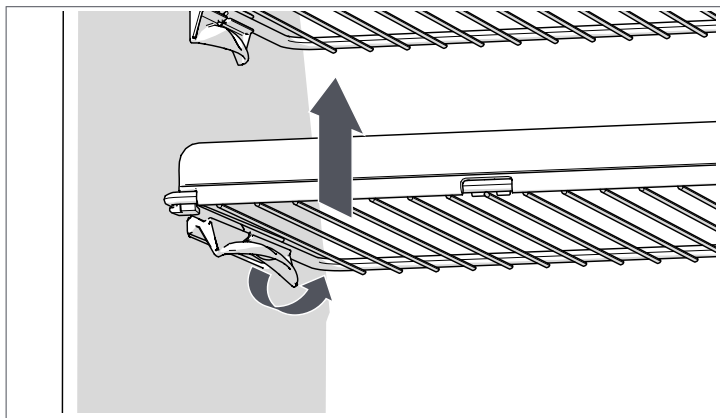

- Move the storage shelf to the desired position.
- Place the right side (side without clamp) of the storage shelf in the refrigerator wall.
- Place the other side (with the clamp) in the corresponding groove.
- Turn the plastic clamp downwards.

### Use of the frozen food compartment

Use the frozen food compartment to store perishable foodstuffs or frozen foods for short periods. Use the frozen food compartment to make ice cubes.



The frozen food compartment temperature cannot be guaranteed if the refrigerator performs in a vehicle interior temperature below 10°C. Food might defrost.

To make ice cubes:

- Fill 2/3 of the ice-cube tray with water.



Make sure you only use drinking water.

- Put the ice-cube tray in the frozen food compartment.



To speed up the process, make ice-cubes at night, when the refrigerator has more capacity.



Place the ice-cube tray in an empty frozen food compartment at the back for the fastest result.

## While driving

To make sure no products in the refrigerator can move while driving:

- Secure the bottles in the door with the bottle retainer, bottles and large products in the drawer with drawer dividers and raise the shelf food retainers to hold the products on the shelves.

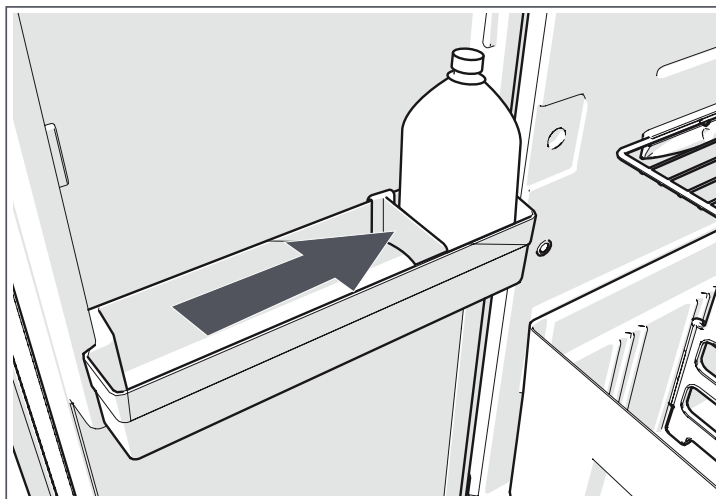

- Close the refrigerator door.



When you push to close the door of the refrigerator, the door locks automatically. While driving this door lock also secures the door.

Some models (N4175 and N4208 only) have an extra security lock on the bottom of the refrigerator. To be sure the door will not open while driving:

- Push the black security lock over the pin on the door.

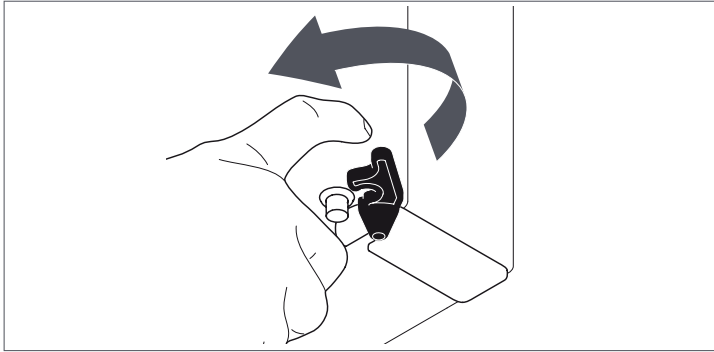

## Winter use

- When you are going to use the refrigerator with an outside temperature below 6°C, install a suitable winter cover at the vents.
- i** This cover will protect your refrigerator against too cold air and makes sure the refrigerator will still perform optimally.
- Make sure you remove the winter cover again once the temperature is above 6°C.

## 6. Maintenance and cleaning



Read the applicable instructions in chapter Safety first.

## Clean

Thetford recommends an annual inspection service by an approved service centre. Clean the refrigerator on a regular basis for optimal performance.

- Always remove any spills or contamination immediately with a mild household cleaner and soft cloth.
- If needed, remove the shelves, door bins, vegetable bins and clean the inside of the refrigerator and loose parts.
- Clean the outside of the refrigerator with a damp soft cloth.



Make sure the vents on the outside of the vehicle are always dust-tight.



### Replace a secured storage shelf (model N4141)

- Remove the screw that is placed in the shelf near the shelf clamp.

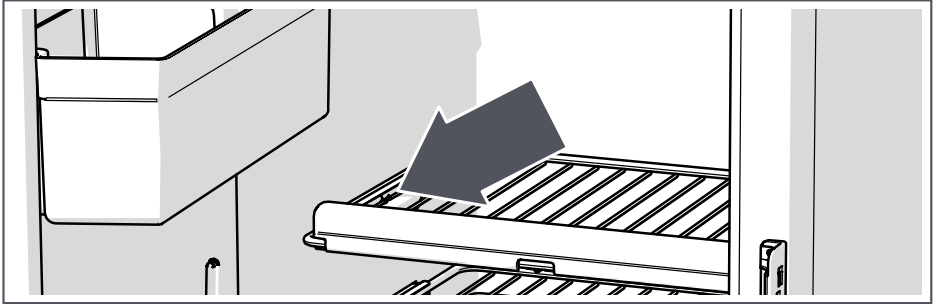

- Turn the plastic clamps of the storage shelf upwards.
- Lift the left side a bit.

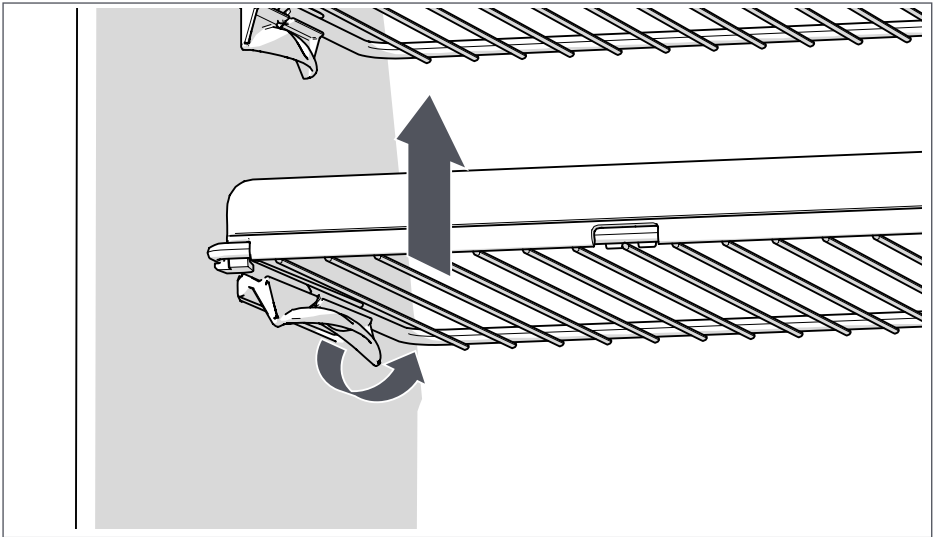

- Remove the storage shelf.

To replace the secured storage shelf after maintenance:

- Place right side (side without clamp) of the storage shelf in the refrigerator wall.
- Place the other side (with the clamp) in the corresponding groove.
- Turn the plastic clamp downwards.
- Replace the screw.

### Replace a secured storage shelf (models N4175 and N4208)

- Place a tool with a flat end firmly inside the oval opening of the clip (1).
- Hold the block under the clip with your free hand (2).

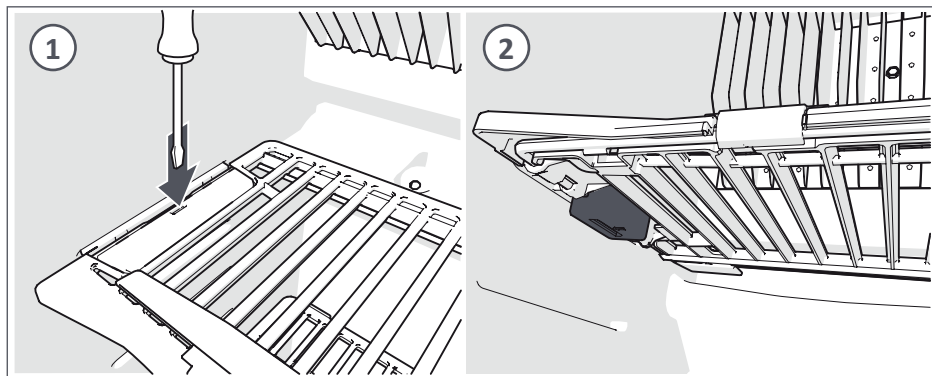

- Gently move the tool away from the fridge wall (approximately 30 degrees) while keeping its end on the bottom of the oval opening (3).
- After removing the safety block, rotate the clip upwards to release the shelf (4).

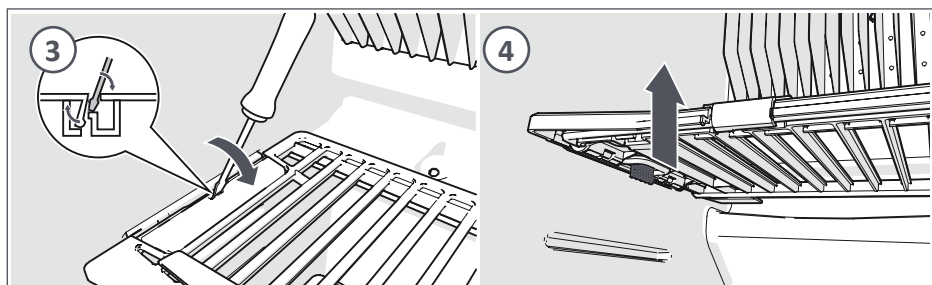

To replace the secured storage shelf after maintenance:

- Place the shelf back in the same position.
- Rotate the clip downwards until the shelf snaps into place.
- Place the block at bottom of the shelf until you hear a click.

### Removing drawer (model N4141)

To remove the drawer for refrigerator model N4141:

- Pull the drawer until the stop and push it a little bit back.

- Then push the guide locks backwards.

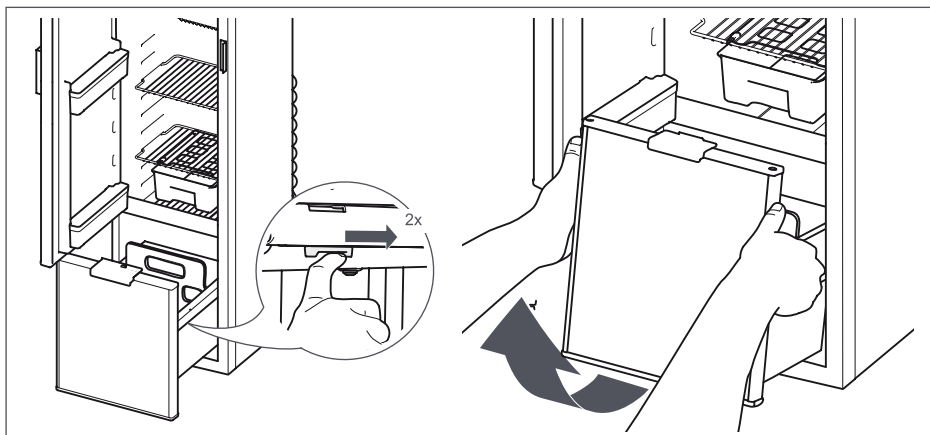

- Pull the drawer further to the front and lift the wheels over the curves.
- Remove and clean the drawer.

To replace the drawer after cleaning:

- Pull out the guides until they snap into place.
- Place the drawer back in reverse order.

## Storage

If the refrigeration appliance is left empty for a long period, switch off, defrost, clean, dry and leave the door open to prevent mould developing within the appliance.

- Empty the refrigerator.
- Defrost the frozen food compartment.
- Clean the complete refrigerator thoroughly.
- Install the winter cover over the vents, to protect your refrigerator during storage.
- Keep the fresh food compartment door, as well as the frozen food compartment door, open during storage.

To keep the door open during storage:

- Open the door.
- N4141: Rotate the hook at the door lock and lock it in place by using the strike plate.

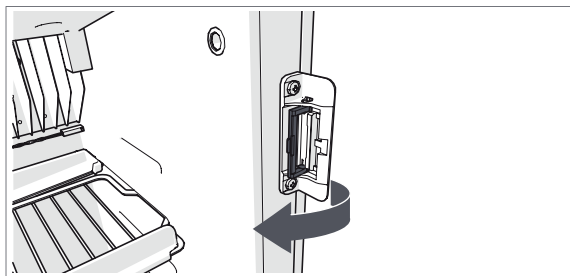

- N4175 and N4208: Rotate the hook at door lock and lock it in place by using the strike plate.

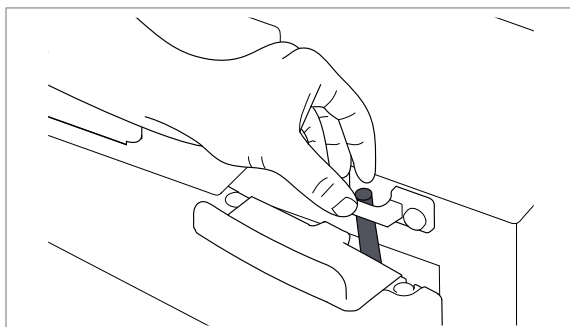

To use the refrigerator after storage:

- N4141: Rotate the hook at the door lock back to its original position.

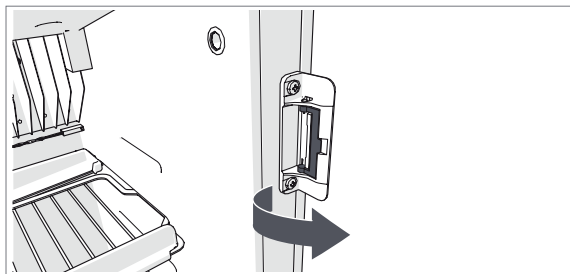

- N4175 and N4208: Rotate the hook at the door lock back to its original position.

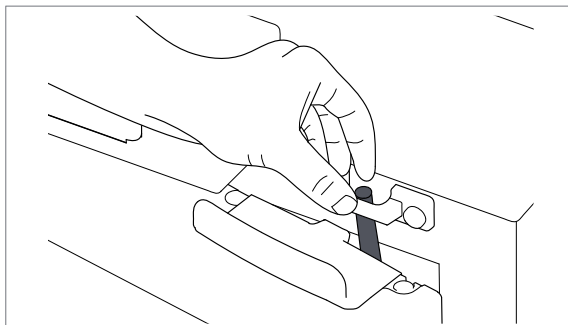

## Defrosting

A layer of ice on the cooling fins will decrease the cooling capacity and durability of your refrigerator. Therefore your refrigerator is provided with an automatic defrost system, which reduces ice formation.

Every 49 hours the refrigerator can start a defrost cycle. The defrost cycle is started if the fin temperature is measured below 1°C and ends when the fin temperature rises above 3°C or when 30 minutes have passed.

It is also possible to defrost your refrigerator manually:

- Remove all food.
- Switch off the refrigerator and open the doors.
- Put a towel in the frozen food compartment and on the bottom of the fresh food compartment to catch any leakage water.

## 7. Disposal



Read the applicable instructions in chapter Safety first.

When your refrigerator has reached its end of life, dispose the product according to the local rules. Do not dispose the refrigerator with normal household waste.

### Environmental Protection



Discarded electric appliances are recyclable and should not be discarded in the domestic waste. Please actively support us in conserving resources and protecting the environment by returning this appliance to the collection centres (if available).

## 8. Technical specifications

### Refrigerator specifications

Model	Dis- play	Total vol- ume (L)	Vol- ume cabi- net (L)	Vol- ume frozen food comp. (L)	Energy consumption				Net weight (kg)
					(kWh/24h)		(g/24h)		
					by 16°C	by 32°C	by 16°C	by 32°C	
N4141	LCD	134	118.4	15.4	2.8	5.5	290	540	38
N4175	LCD	166	135.5	30.3	2.7	5.4	400	600	45
N4208	LCD	199	155.9	42.9	2.4	6.2	300	550	53

*Above volumes per AS/NZS 5263.1.5:2019, effective 1st Sept 2021. The energy consumption is based on the AS/NZS IEC 62552.3:2018 standard.*

## 9. Service & questions



Read the applicable instructions in chapter Safety first.

### Service

Before any service work is started, disconnect the appliance from electrical supplies.

### Troubleshooting

Problem	Possible cause	Solution
Refrigerator does not start	Refrigerator is not switched on	Switch on the refrigerator
	Vehicle is not level	Make sure the vehicle is level
		Try to start the refrigerator on another power source
Model with LCD display: Error codes 1, 2, 4, 5, 8, 9, 12 or 13 light up on the control panel	Multiple causes	Switch the refrigerator off and on again. If the problems still exist, contact a service centre

Problem	Possible cause	Solution
Error code 3 Refrigerator does not work on gas	Gas bottle is empty	Replace the gas bottle
	The valve of the gas bottle and/or the shut-off valves are closed	Open the valves
	Refrigerator is not switched on	Switch on the refrigerator
		Try to run the refrigerator on another power source
Error code 6 or 7 Refrigerator does not work on 12V	The engine is not running	Make sure the engine is running
	12V fuse faulty	Check if the 12V fuse in the fuse box of your motor home or car is still operational
		Try to run the refrigerator on another power source
Error code 10 Refrigerator does not work on 230V	Mains are not available	Check if the mains is available
		Try to run the refrigerator on another power source
Error code 11 Refrigerator does not work in Auto	Sources are not connected	Connect the sources
		Try to run the refrigerator on another power source manually
Error code 18: All symbols light up		Wait a few seconds until the refrigerator starts normally
All lights are blinking		Switch the refrigerator off and on again. If the problems still exist, contact a service centre
Refrigerator has insufficient cooling	Ventilation openings completely or partially blocked	Clean or remove blockage
	Vehicle is not level	Make sure the vehicle is level





## EUROPEAN HEADQUARTERS

Thetford B.V.  
P.O. Box 169  
4870 AD Etten-Leur  
The Netherlands

T +31 76 504 22 00  
F +31 76 504 23 00  
E [info@thetford.eu](mailto:info@thetford.eu)

## UNITED KINGDOM

Thetford Ltd.  
Unit 6  
Brookfields Way  
Manvers, Rotherham  
S63 5DL, England  
United Kingdom

T +44 844 997 1960  
F +44 844 997 1961  
E [info@thetford.eu](mailto:info@thetford.eu)

## GERMANY

Thetford GmbH  
Schallbruch 14  
D-42781 Haan  
Deutschland

T +49 2129 94250  
F +49 2129 942525  
E [info@thetford.eu](mailto:info@thetford.eu)

## FRANCE

Thetford S.A.R.L.  
Parc BUROPLUS / Bâtiment 6  
18, Boulevard de la Paix  
CS 80008  
95895 Cergy Pontoise Cedex  
France

T +33 1 30 37 58 23  
F not available  
E [info@thetford.eu](mailto:info@thetford.eu)

## ITALY

Thetford Italy c/o Tecma s.r.l.  
Via Flaminia  
Loc. Castel delle Formiche  
05030 Otricoli (TR)  
Italia

T +39 0744 709071  
F +39 0744 719833  
E [info@thetford.eu](mailto:info@thetford.eu)

## SPAIN AND PORTUGAL

Mercè Grau Solà  
Agente para España y Portugal  
C/ Castellet, 36 bxs 2a  
08800-Vilanova i la Geltrú  
Barcelona  
España

T +34 938 154 389  
F not available  
E [info@thetford.eu](mailto:info@thetford.eu)

## SCANDINAVIA

Thetford Scandinavia  
Bangatan 6  
521 43 Falköping  
Sverige

T +46 31 336 35 80  
F not available  
E [info@thetford.eu](mailto:info@thetford.eu)

## AUSTRALIA

Thetford Australia Pty. Ltd.  
130-132 Freight Drive  
Somerton VIC 3062  
Australia

T +61 3 9358 0700  
F not available  
E [info@thetford.com.au](mailto:info@thetford.com.au)  
[www.thetford.com.au](http://www.thetford.com.au)

## CHINA

Thetford China  
Rm. 1207, Coastal Building  
(East Block)  
Haide 3rd Road, Nanshan District  
Shenzhen, 518054  
China

T +86 755 8627 1393  
F +86 755 8627 1673  
E [info@thetford.cn](mailto:info@thetford.cn)  
[www.thetford.cn](http://www.thetford.cn)